

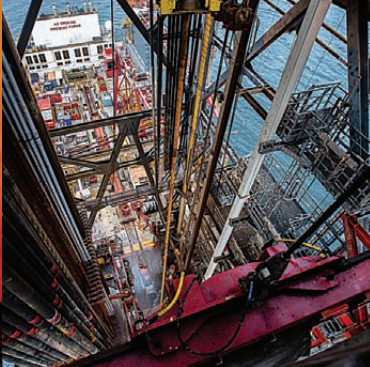

OCTG Accessories and Solutions



OCTG Accessories and Solutions



About Us

Vallourec offers an extensive array of accessories and services to meet the most challenging needs, from tubular accessories to well coordination.

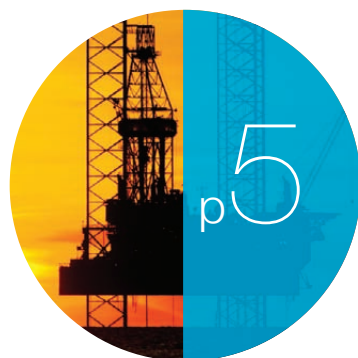

Tubing & Casing Accessories

Equipment used to connect, allow change of diameters, and adapt string to well conditions. Well integrity is strengthened.



Surface Equipment

Equipment used to run casing and tubing into the well and to assist and facilitate fluid circulating operations.

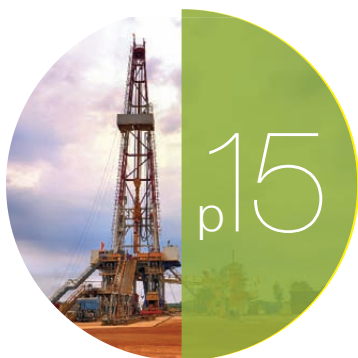

Completion Accessories

Tubular accessories installed with the tubing string to customize and complete the well helping to have safe and efficient production.

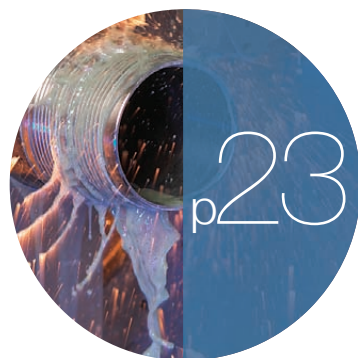

Services

- › Premium Threading Services
- › Well Coordination



Specialty Products

- › Base Pipe
- › Self-Alignment Solution: VAM® IN-LINE
- › Thermal Solution: THERMOCASE®

lo
vallourec



About Us

Vallourec offers an extensive array of accessories and services to meet the most challenging needs, from tubular accessories to well coordination.



Vallourec Group

Vallourec is a leading world manufacturer of seamless steel tubes and specific tubular products for industrial applications. Specializing in the most complex and highly-demanding industrial applications (extreme temperatures, pressures, and corrosion), notably in the energy sector, the Group offers a portfolio of diversified, unique and high value-added tubular products. Production facilities on four continents, complemented by a worldwide network of sales offices and service centers, ensure a global presence for its customers.

Its Oil & Gas Division is recognized worldwide for its commitment to extreme environment solutions. The high-tech products designed and developed by the Oil and Gas Division meet the reliability requirements of the most demanding customers. They include plain-end or threaded seamless tubes and casing for oil and gas production with standard API or VAM® premium connections for a variety of applications.





VAM®

VAM® has been the leading brand of premium connections for the Oil & Gas industry for over 50 years. As wells conditions become more hostile, VAM® designs new connections, extends product lines and qualifies new sizes to the most stringent specifications to meet customer needs.

Operator safety, well life and return on investment rely on the quality of our products. The performance of all VAM® connections are validated through full scale physical testing at our R&D centers to fully respond to those requirements.

VAM® is committed to design connections suited for a variety of conditions including elevated temperature, extreme temperature fluctuations, HP/HT, sour service, extreme frac pressures, high torque, fatigue loading and severe dog legs.

In 2008 the Atlas Bradford® connections were added to the VAM® offering, providing our customers a comprehensive and perfectly integrated product range for all technical requirements.

VAM® benefits from a worldwide footprint of production facilities, three leading edge R&D Technology centers and a worldwide network.



Vallourec Accessories

Pioneer and world class continuing leader, Vallourec Accessories has served the Oil & Gas industry as a leading service provider of specialized tubular accessories, engineered products and premium threading.

Our commitment is to bring value to our customers through the highest quality products and services. Our experienced employees are always motivated to understand and support customer's specific needs and to build long term relationships by providing exceptional customer service.

Our operations benefit from Vallourec's global manufacturing sites to support our capabilities. With an international industrial and commercial footprint Vallourec Accessories is present in all the major Oil & Gas hubs worldwide focusing specially on Operators and Service Companies.

From a single Flo-pup® to complete project coordination, Vallourec Accessories delivers the right products and services on time, and at the best cost.

Benefits for Customers

- › Mitigate risks for the life of the well
- › Cost & time efficiency
- › Minimize running time
- › Improve productivity
- › Full VAM® connections portfolio available
- › Enable customers to focus on their know how
- › Customize equipment to reduce total cost of ownership
- › Full Technical support on VAM® connections and interface with equipment
- › Available with Vallourec grades and material



Tubing and Casing Accessories

Equipment used to connect, allow change of diameters, and adapt string to well conditions. Well integrity is strengthened.

Crossover

A crossover is a one piece tubular section used to join or change two different components with different size of tube, or type of connection. These components can be casing, tubing, drill pipe or combination. Crossovers are also known as Xover, XO, XOs, crossover sub, crossover pup, swage nipple, connectors, double pin subs, change over subs, waterbushing, circulating heads

Size Range

OD: All combinations available from 2" to 24"

Available Lengths

- 2', 3', 4', 6', 8', 10' & 12'
- Standard length: 3'

Connection

- All API connections
- All VAM® OCTG and drilling connections
- Other connections upon request

Material Type

- Standard OCTG pipe and coupling stock
- Mechanical steel from tubes or bars

Material Grades

- All API grades available
- Standard Vallourec proprietary grades available
- Chromium grades: 13Cr, S13Cr, CRA, etc.
- High performance Vallourec proprietary grades
 - High Collapse available by design
 - Sour Service (S or SS) available in Nickel alloy

Performance

- Same as string
- Clearance same as string
- Hydro-test can be performed on request



Coupling

Couplings are short subassemblies used to enable two components with the same connection and size to be connected. Couplings are also known as loose coupling and spare coupling.

Size Range

OD: 2 3/8" to 24".

Available Lengths

- › According to API and VAM® drawings
- › Extended lengths on special request

Connection

- › All API T&C connections
- › All VAM® OCTG T&C connections
- › Other connections available upon request

Material Type

Standard OCTG coupling stock

Material Grades

- › All API grades available
- › All Vallourec proprietary grades available

Performance

- › According to VAM® brochures
- › No Hydro Test



Pup Joint

A pup joint is a short casing or tubing used for handling production tubing assemblies and for spacing out full length tubing and casing strings. Pup joints are also known as saver sub, spacer and pup.

Size Range

2 3/8" to 24"

Available Lengths

- 2', 3', 4', 5', 6', 8', 10' & 12'
- Casing range 1 (16' to 25')
- Tubing range 1 (20" to 24")
- Standard length: 6'
- Standard tolerance: +/-3" (76,20 mm)

Connection

- All API T&C connections
- All VAM® OCTG T&C connections
- All VAM® OCTG Integral connections
- Other connections available upon request

Material Type

Standard OCTG pipe and coupling stock

Material Grades

- All API grades available
- All Vallourec proprietary grades available including stainless steel and high alloys

Performance

- Pipe body: Same as string
- Connection: Same as string according to connection performance



Nipple

A nipple is a pup joint delivered without a coupling and with male threads on both ends. It is used for handling production tubing assemblies and for spacing out full length tubing and casing strings. Nipples are also called saver sub, spacer, pup and pin x pin pup joint.

Size Range

OD: 2 3/8" to 24".

Available Lengths

- › 2', 3', 4', 5', 6', 8', 10' & 12'.
- › Casing range 1 (16' to 25')
- › Tubing range 1 (20" to 24")
- › Standard length: 6'
- › Standard tolerance: +/-3" (76.20 mm)

Connection

- › All API T&C connections
- › All VAM® OCTG T&C connections
- › All VAM® OCTG Integral connections
- › Other connections available upon request

Material Type

Standard OCTG pipe and coupling stock

Material Grades

- › All API grades available
- › All Vallourec proprietary grades available including stainless steel and high alloys

Performance

- › Pipe body: Same as string
- › Connection: Same as string according to connection performance





Surface Equipment

Equipment used to run casing and tubing into the well and to assist and facilitate fluid circulating operations.

Waterbushing

Waterbushing can be a surface or casing accessory for safety purpose. It is used for circulating the string hydro test up to 6000 psi. In case of gas kick, it allows to put the string at the bottom of the well and to close the BOP to seal the well. It is able to lift the full string and can be used for OCTG and drill pipe.

Size Range

- OCTG: 5" to 24"
- Drill: 3 1/2" to 7 5/8"

Available Lengths

2.5' to 4'

Connection

- Drill end
 - All API drill connections
 - All VAM® drill connections
 - Other proprietary drill connections available upon request
- OCTG end
 - All API T&C connections
 - All VAM® OCTG T&C connections
 - All VAM® OCTG Integral connections
 - Other connections available upon request

Material Type

Round bar, mechanical steel

Material Grades

Yield strength min 110ksi, 125 ksi or 135 ksi
(No API or Vallourec proprietary grades)

Performance

Limited by OCTG or drill connection

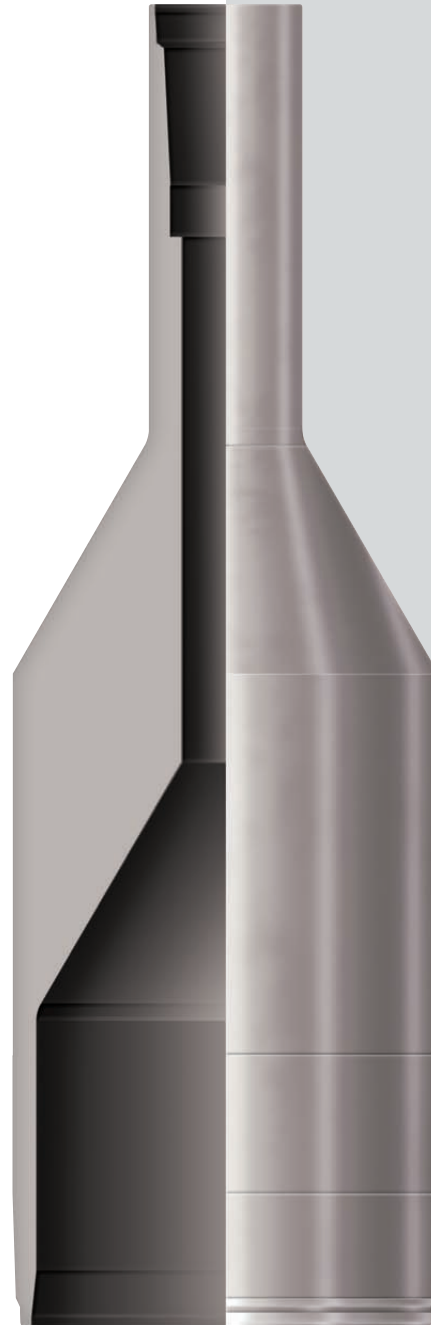

Circulating Head OCTG

Circulating Head is used for circulating the string hydro test up to 6000 psi. Maximum weight is 250kg and it cannot be used to lift the full string. Circulating Head is also known as circulating swedges, waterbushing OCTG x WECO, cross over OCTG x WECO and pump-in sub (WECO and hammer union are interchangeable).

Size Range

- OCTG: 5" to 24"
- Hammer union: Generally 1502 2"

Available Lengths

1.5' to 3'

Connection

- Hammer union end
 - Generally 1502 2"
- OCTG end
 - All API T&C connections
 - All VAM® OCTG T&C connections
 - All VAM® OCTG Integral connections
 - Other connections available upon request

Material Type

Round bar, mechanical steel

Material Grades

Yield strength min 110ksi or 125 ksi
(No API or Vallourec proprietary grades)

Performance

- Internal pressure up to 6000 psi
- Lifting with the hammer union: 200kg max.
- Cannot lift the full string

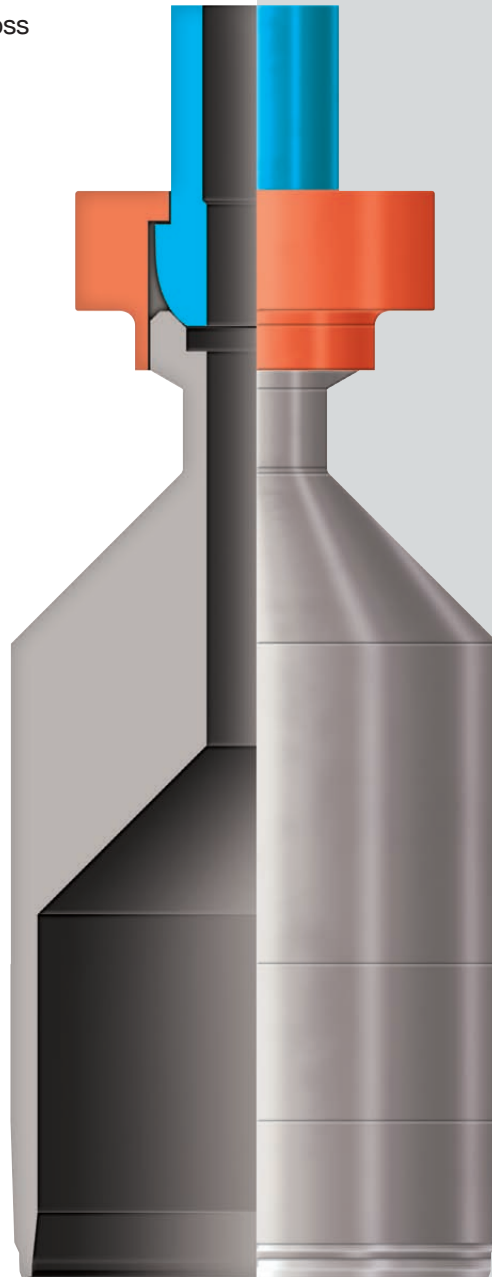

Drift Mandrel

Drift Mandrel is a test piece to control the free pass in the internal diameter of the pipe and connection.

Size Range

2 3/8" to 24"

Available Lengths

6", 12", 42"

Connection

No connection

Material Type

Carbon, Aluminium or Teflon / UHMW-PE

Material Grades

Not applicable

Performance

No performance, shall ensure 500 uses



Lifting Equipment

Lifting equipments are tools able to lift pipe that cannot be handled by the coupling face from horizontal to vertical position. Lifting equipments are also known as lifting nubbins, lifting devices, lifting plug long and lifting plug short.

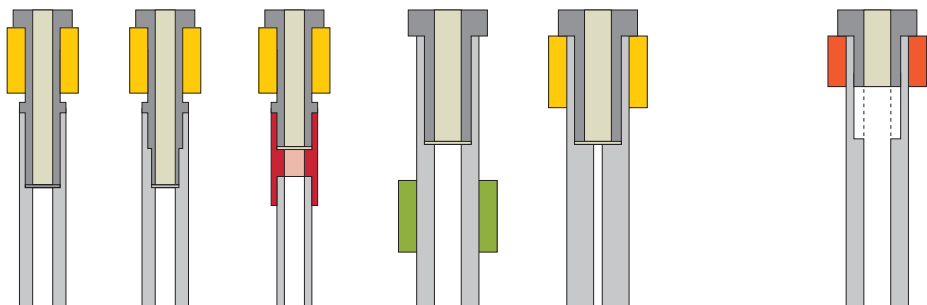
| Name | Lifting Sub ⁽¹⁾ | Lifting Plug | Handling Plug |
|---|---|---|--|
| String connection type | For flush, semi flush or T&C | For flush only For semi flush lifting sub is mandatory | For flush only For semi flush, lifting sub is mandatory |
| Lifting tool connection type | Full thread length | Full thread length | Reduced thread length |
| Lifting tool capacity | Lower than the string connection due to safety factor | Lower than the string connection due to safety factor | 3 pipes (1 stand) maximum |
| Recommended elevator type | Side door elevators Lifting on lifting sub face | Slip type elevators grip below connection Use safety plug as a safety device | Single joint or side elevators |
| Alternate elevator type | Slip type elevators grip on lifting sub body | Side door elevators lifting on lifting plug face | |
| Other remarks | Compatible with standard elevator designs No ferrous contamination in case of CRA pipe | For CRA pipe, lifting sub is mandatory | For CRA pipe, lifting sub is mandatory |
| Max weight | Depending on pipe OD Can be higher than 50kg/110lb | Depending on pipe OD Can be higher than 50kg/110lb | Max 25kg/55lb |
| Overall length | Pipe OD>7" : OAL 31.50" Pipe OD>7" : OAL 27.60" | Lifting tool connection length +4" | Lifting tool connection length +2" |
| <div> <div></div> Side door elevator <div></div> Slip type elevator <div></div> Single joint elevator <div></div> Coupling </div> |  | | |

Note:

The maximum weight that can be lifted with a lifting sub (design 1 to 3) is the lesser of either the tool or connection tensile strength. These values are a factor of material strength.

VAM® designed lifting tools have low interference threads and no contact on the metal-to-metal seal surfaces. They can be made-up using a chain tong until there is no gap between the lifting tool face and the end of the pipe.

In all cases, the threads of the lifting devices shall be machined by a VAM® Licensee.

The VAM® family has “proprietary” designs available which address most situations and can be offered with the required VAM® threads as well as specific surface treatment (use with CRA pipe). The designs are optimized for weight limitation.

Size Range

- 2 3/8" to 24"
- Rear part OD is pipe OD +1.5"

Connection

All VAM® OCTG connections

Material Type

Mechanical carbon steel (41XX or higher)

Material Grades

- Yield strength min 125 ksi
- Mechanical properties guaranteed:
only tensile test with yield strength min
and ultimate tensile strength min

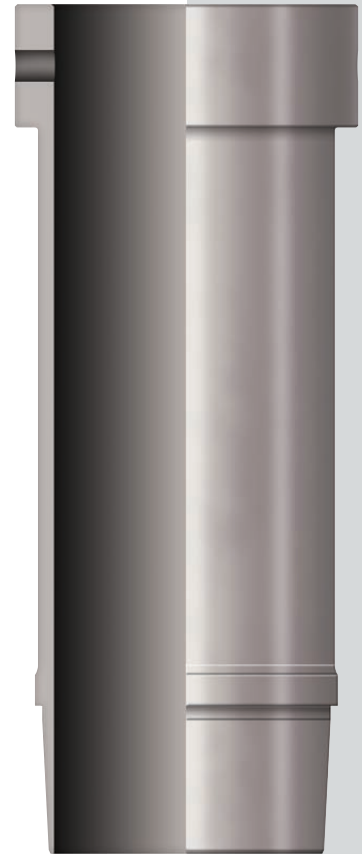

Lifting Sub



Lifting Plug



Handling Plug



Completion Accessories

Tubular accessories installed with the tubing string to customize and complete the well helping to have safe and efficient production

Flow Coupling

Flow couplings are heavy wall tubes which are run as an integral part of the tubing string. The purpose of a flow coupling is to reduce the effect of internal erosion caused by turbulent flow.

Size Range

2 3/8" to 7" (Bigger sizes available upon request)

Available Lengths

Generally $\leq 12'$

Connection

- All API T&C connections
- All VAM® OCTG T&C connections
- All VAM® OCTG Integral connections
- Other connections available upon request

Material Type

Standard coupling stock, mechanical pipe, round bar

Material Grades

- All API grades available
- All Vallourec proprietary grades available including stainless steel and high alloys

Performance

Same as string



The Flo-Pup® is an original innovation of Vallourec Accessories. This unique product combines a pup joint and flow coupling into a single unit. The Flo-Pup® eliminates unnecessary threaded and coupled connections and potential leak paths in down-hole assemblies reducing the cost of the completion.

Size Range

2 3/8" to 4 1/2"

Available Lengths

Generally ≤12'

Connection

- › All API T&C connections
- › All VAM® OCTG T&C connections
- › All VAM® OCTG Integral connections
- › Other connections available upon request

Material Type

Standard coupling stock and mechanical steel

Material Grades

- › All API grades
- › All Vallourec proprietary grades available including stainless steel and high alloys.

Performance

- › Pipe body: Same as string
- › Connection: Same as string according to connection performance.



Blast Joint

Blast Joints are heavy wall tubes which are run as an integral part of the tubing string. The purpose of a Blast Joint is to minimize the effect of external erosion action. Blast Joints can be located opposite to perforations in dual completions or directly below the tubing hanger in sand frac situations.

Size Range

2 3/8" to 7" (Bigger sizes available upon request)

Available Lengths

≥10'

Connection

- All API T&C connections
- All VAM® OCTG T&C connections
- All VAM® OCTG Integral connections
- Other connections available upon request

Material Type

Standard coupling stock, round bar and mechanical steel

Material Grades

- All API grades available
- All Vallourec proprietary grades available

Performance

Same as string



Landing Nipple

Landing nipples are devices which are integral parts of the tubing string. They are manufactured with specific internal profiles which provide predetermined locations in the tubing string where down-hole control devices can be landed and retrieved by wire line or coiled tubing.

Types

All major OFS types of profiles available upon request

Size Range

2 1/16" to 4 1/2"

Available Lengths

Typically 15" to 20"

Connection

- › All API connections
- › All VAM® OCTG T&C connections
- › All VAM® OCTG Integral connections
- › Other connections available upon request

Material Type

Standard coupling stock and mechanical steel

Material Grades

- › All API grades available
- › All Vallourec proprietary grades available

Performance

- › Rated working internal pressure 10000 psi
- › Connection: Same as string



Wireline Re-Entry Guide

Wireline re-entry guide is run at the bottom of the completion string to guide wireline tools that have been run below the end of the string back into the string. Different shape at the bottom of part according to use.

Size Range

2 3/8" to 7"

Available Lengths

1' to 3'

Connection

- All API connections
- All VAM® OCTG T&C connections
- All VAM® OCTG Integral connections
- Other connections available upon request

Material Type

Coupling stock

Material Grades

- All API grades available
- All Vallourec proprietary grades available

Performance

As requested by customer



Mule Shoe

A Mule Shoe is a small tubing that is attached on the bottom of a drill string. The device guides the casing toward the center of the hole and minimizes problems associated with hitting rock ledges or washouts in the wellbore as the casing is lowered into the well. The bottom part can be shaped differently depending on the use.

Size Range

2 3/8" to 7"

Available Lengths

1' to 3'

Connection

- › All API connections
- › All VAM® OCTG T&C connections
- › All VAM® OCTG Integral connections
- › Other connections available upon request

Material Type

Coupling stock

Material Grades

- › All API grades available
- › All Vallourec proprietary grades available

Performance

As requested by customer



Bull Plug

Bull plug is a short part with one threaded end and one rounded closed end that is used to plug off the bottom end of down-hole logging instruments from borehole fluids.

Size Range

2 3/8" to 4 1/2"

Available Lengths

6" to 18"

Connection

- All API connections
- All VAM® OCTG T&C connections
- All VAM® OCTG Integral connections
- Other connections available upon request

Material Type

Round bars

Material Grades

- All API grades available
- All Vallourec proprietary grades available
- Preferable yield strength min 125 ksi in mechanical steel 4130, 4140 or equivalent

Performance

As requested by customer

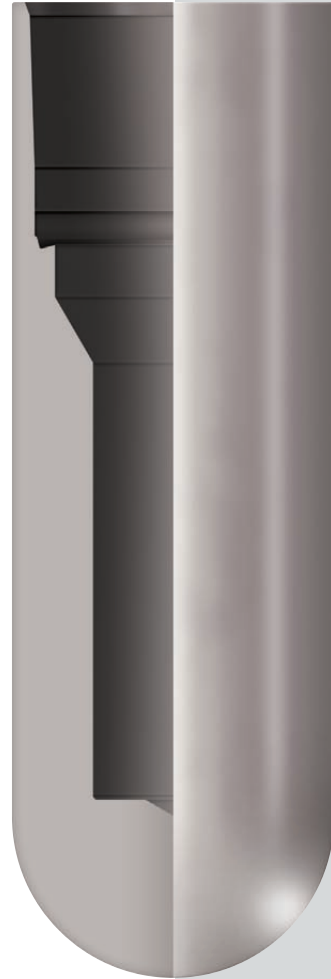

Testing Plug / Test Cap

Testing plugs / test caps are screwed at both ends of an accessory or assembly. They allow performing Hydro Test up to the MIYP of the part. Testing plugs are also known as test nubbins.

Test fixture can be available for rental.

Configuration

Two configurations exist:

- Metal to metal seal
- Low torque with seal ring

Size Range

2 3/8" to 16"

Available Lengths

Overall length per Vallourec design:

- Test Plug: Connection MUL + 6.300" for make-up
- Test Cap: Connection MUL+ 0.787 for make-up + bottom length

Connection

- All VAM® OCTG T&C connections
- All VAM® Integral connections
- Low interference thread option subject to VAM® Field Service approval

Material Type

Round bars, 41XX or higher

Material Grades

Yield strength min: 125 ksi or 150 ksi

Performance

From 3000 psi to 10 kpsi or 15Kpsi according to the MIYP of the tested piece

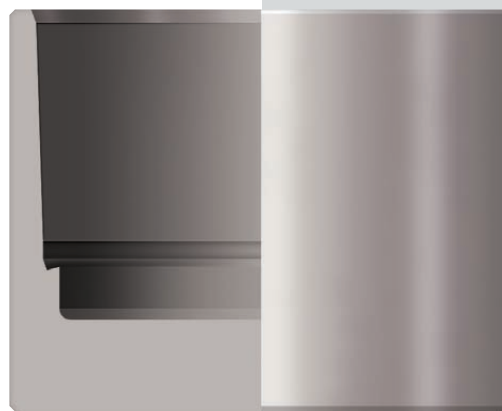

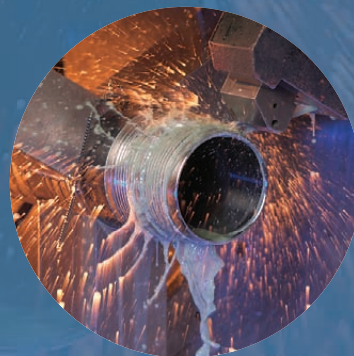

Services

- › Premium Threading Services
- › Well Coordination

Premium Threading Services

Complex threading and machining is Vallourec Accessories's specialty. Vallourec Accessories applies a wide range of VAM®, API, and other premium threading services on tubing, casing, customer's specialized equipment and drill pipe in sizes up to 22 inches at its facilities or at customer locations.

Vallourec's experienced machinists use a proven, best-in-class threading process that includes in-house inspections with specialty gauges and testing to ensure precise thread designs and tolerances are met. Vallourec Accessories also provides comprehensive repair capabilities.



Licenses

- › VAM®
- › Atlas Bradford
- › API
- › Other Premium Connections

Certifications

- › ISO 9001
- › ISO 14001
- › OHSAS 18001
- › API Q1
- › API 5CT
- › API 7-1
- › Licensee Specifications

Special Finish

- › Zinc phosphate
- › Manganese phosphate
- › Copper plating

Testing

- › Wet and dry magnetic particle inspection
- › Ultrasonic



Premium Threading Services

- › Tubing / casing hangers
- › Float equipment
- › Cementing equipment
- › Polish bore receptacles
- › Mandrels
- › Safety valves
- › Packers
- › Landing collars
- › Seal assembly
- › Others

Well Coordination

Consolidating services from one central facility is extremely beneficial to the customer. Simplifying logistics saves time and expenses normally associated with separate services, resulting in faster, more cost-effective delivery. Services to our customers include specialized manufacturing, make-up, testing, loading and shipping to the rig site, all from a centralized location.

Offshore baskets are available for purchase or rent to aid in the handling and shipment of assemblies. They are ideal for shipments of CRA materials and can be bolstered for protection. Baskets can be custom built to a variety of specifications. Deep water boat slips are maintained in appropriate areas to enable loading of a wide range of vessels.

Both indoor and outdoor storage of customer properties is available on site.

In the last 10 years, Vallourec and its partners have serviced over 200 well completions for major deep water projects.



Assembly and Testing

Vallourec along with partners, possesses the latest in hardware and software for computer controlled make-up of tubular products, including non-marking make-up for special materials. Hangers, safety valves, landing nipples, gas lift mandrels, chemical injection mandrels and sliding sleeves are just a few of the assemblies that can be made up. Each package is tailored to provide the exact solution a customer requests. Assemblies can be drifted and hydrostatic or nitrogen-tested after make-up.



Specialty Products

- › Base Pipe
- › Self-Alignment Solution:
VAM® IN-LINE
- › Thermal Solution:
THERMOCASE®

Base Pipe

Base pipe is a full length tubing or casing that can be perforated with holes/slots, used as the backbone for sand screen joints or swellable packers. Sand screen joints are manufactured starting from base pipe on which layers of mesh are welded. Screens are used to filter the sand in the reservoir and to prevent it from coming in the production string. Swellable packers are downhole devices used in completion to isolate the annulus from the production conduit, enabling controlled production, injection or treatment. Pipe can be delivered with holes/slots already perforated. Base pipe is also known as sand screen and perforated pups.

Size Range

2 3/8" to 7"

Available Lengths

- 8', 10', 12'
- Standard tolerance: +/- 3" (76,20mm)
- Range 2: 28' to 32'
- Range 3: 38' to 42'

Connection

- All API T&C
- All VAM® OCTG T&C
- All VAM® OCTG Integral connection
- Other connections available upon request

Material Type

Standard OCTG pipe and coupling stock

Material Grades

- All API grades available
- All Vallourec proprietary grades available

Performance

- Pipe body: Reduced performance due to the perforations
- Connection: Same as string according to connection performance



VAM® IN-LINE

Vallourec's VAM® IN-LINE is an option developed for VAM® threads which guarantee the connections alignment pipe to pipe during the make-up at the rig site.

This option is mainly dedicated to the downhole equipment that requires a controlled positioning around the tubing circumference, relatively to the previous and following joints in the completion.

Main Applications

- Sand screens with shunt pipes

Benefits

IN-LINE allows connection of shunt pipes amongst different Gravel pack assemblies. It guarantees that the shunt pipes attached to every based pipe are aligned, allowing optimal performance of the assembly.

- Accurate positioning of +/- 1/4" pipe to pipe on all dimensions
- No change on the original connection thread design
- User-friendly – no change in the make-up procedure/criteria

Other Applications

- Control lines and other smart connection applications where alignment is required

Connection

The IN-LINE option is fully compatible with all existing options of VAM® connections including special clearance and special bevel coupling.



Vallourec THERMOCASE® is insulated tubing featuring an engineered and durable gettered vacuum system. It is a high-performance double-walled tubular product that provides temperature isolation in response to various oilfield production challenges due to temperatures differences between the reservoir and wellhead.

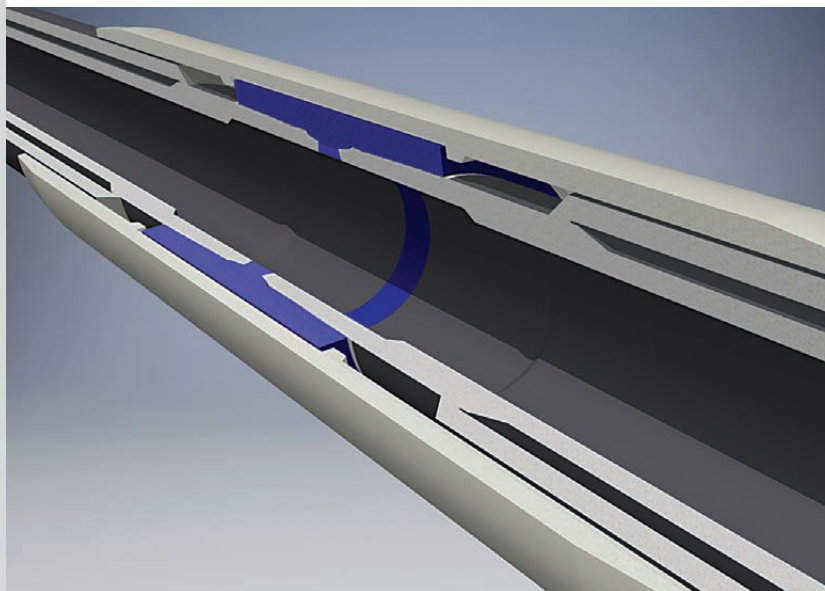

How does THERMOCASE® work?

- THERMOCASE® Vacuum Insulated Tubing VIT is a tubing product where a sealed chamber is formed between two tubes
- Vacuum is pulled in the chamber and serves as the primary insulator in the pipe body
 - Prevents conduction and convection
 - Maintained for years using getters inside the chamber
- Radiation transfer is minimized using Multi-layer Insulation [MLI] inside the vacuum chamber

Main Applications

- Steam injection
- Flow assurance (wax, paraffin, hydrates, etc...)
- Well integrity (APB, natural hydrates, permafrost)
- Tubular applications where temperature/heat management is critical may be suitable for insulated tubing.

Benefits

➤ THERMOCASE® for Steam

- Produce oil earlier - reduce initial stage by about one month
- Step change improvement on energy loss to vertical and build section
- Reduces steam to oil ratios

➤ THERMOCASE® for flow assurance

- Increase flowing temperature at wellhead by as much as 60°C by capturing down hole temperature and preventing heat loss during travel to surface
- Increases flow rates

- Increases shut-in time window when starting production

- More reliable and cost efficient artificial lift

➤ THERMOCASE® for well integrity

- Very efficient preventive solution
- Fully reversible, not just one shot solution like crushable components or burst disks
- Fully passive solution, no added cost during service, demonstrated efficiency after more than 10 years of service

➤ THERMOCASE® for all applications

- Runs like tubing, VIT can easily be placed where needed
- Reduce complexity of work over compared with other insulation techniques
- Fully passive solution, no added cost during service
- Reduces thermal growth on well head
- Length of VIT can be optimized to desired temperature management objectives

Configuration

- Model 750™ Offers maximum tensile loading of outer tube
- Customization: Slim, upset, R2, R3 lengths
- Configuration can be maintained for repeated future orders
- Model 970™ Offers increased annular clearance
- Customization: Slim, upset, R2, R3 lengths
- Configuration can be maintained for repeated future orders

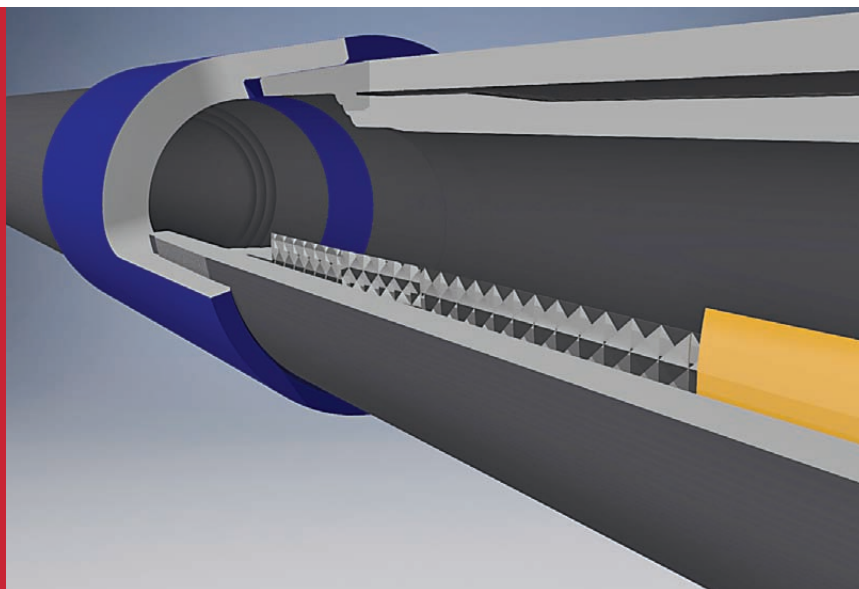

Size Range

From 1.9" inner pipe to 16" outer pipe

Available Lengths

- Range 2: 28' to 32'
- Range 3: 38' to 45'

Connection

- All API T&C
- Semi-premium connections like DWC™
- All VAM® OCTG T&C
- All VAM® OCTG Integral connection
- Other premium connections

Material Type

Standard OCTG pipe

Material Grades

- J55, L80 for Steam
- L80, 13CR L80, Super 13Cr from 95 to 125 ksi and CRA for all production tubing application

Performance

- First class thermal efficiency:
 - Energy loss factor:
 - Carbon steel pipe: 50 Watts / meter and Kelvin
 - THERMOCASE®: 0.011 Watts / meter and Kelvin
- THERMOCASE® offers the highest level of thermal insulation available in a down-hole tubular with proven minimum 10 year service life and worldwide installations in the most severe environments

Leader in Premium Tubular Solutions



SALES CONTACTS

> NORTH AMERICA

USA

Sales.VTA-USA@vallourec.com

Mexico

contacto.octg-mex@vallourec.com

> EUROPE & AFRICA

sales.accessories.ea@vallourec.com

> SOUTH AMERICA

vendas.octg-bra@vallourec.com

> ASIA PACIFIC & CHINA

dlsgpvta@vallourec.com

> MIDDLE EAST

sales.accessories.me@vallourec.com



Get the Vallourec Oil & Gas mobile app.

VAM®, **VAM** are registered trademarks of Vallourec Oil and Gas France
THERMOCASE® is a registered trademark of Vallourec Tube-Alloy, LLC





Visit our Website
www.vallourec.com

